

electriciQ

USER MANUAL

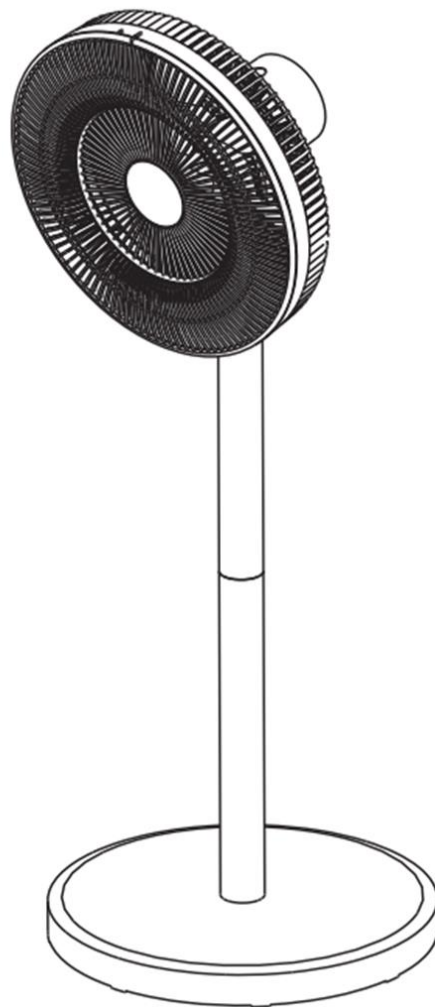

FLOOR STANDING FAN DCF12P

Thank you for choosing electriciQ

Please read this user manual before using this air circulator and keep it safe for future reference.

Visit our page www.electriQ.co.uk for our entire range of Intelligent Electricals

CONTENTS

SAFETY	3
FEATURES	4
PRODUCT DIAGRAM	4
OPERATION	5
REMOTE CONTROL	5
MAINTENANCE	6
TROUBLESHOOTING	6
TECHNICAL SPECIFICATION	7
SUPPORT	7

SAFETY INSTRUCTIONS

- Carefully read the instructions before operating the unit
- This appliance is for indoor use only.
- Rating: This unit must be only connected to a 220-240 V / 50 Hz earthed outlet.
- Installation must be in accordance with regulations of the country where the unit is used.
- If you are in any doubt about the suitability of your electrical supply have it checked and, if necessary, modified by a qualified electrician.
- This fan has been tested and is safe to use. However, as with any electrical appliance - use it with care.
- Disconnect the power from the unit before dismantling, assembling or cleaning the unit
- Avoid touching any moving parts of the appliance.
- Never insert fingers, pencils or any other objects through the guard
- This appliance can be used by Children aged from 8 years and above and persons with reduced physical, sensory or mental capabilities or lack of experience and knowledge if they have been given supervision or instruction concerning use of the appliance in a safe way and understand the hazards involved. Children shall not play with the appliance. Cleaning and user maintenance shall not be made by children without supervision.
- Do not clean the unit by spraying or immersing it in water.
- Never connect the unit to an electrical outlet using an extension cord. If an outlet is not available, one should be installed by a qualified electrician.
- Never operate this appliance if the cord or plug is damaged. Ensure the power cord is not stretched or exposed to sharp object/edges.
- A damaged supply cord should be replaced by the manufacturer or a qualified electrician in order to avoid a hazard.
- Any service other than regular cleaning should be performed by an authorized service representative. Failure to comply could result in a voided warranty.
- Do not use the appliance for any purpose other than for its intended use.
- Never use the mains plug as a switch to start and turn off the fan. Use the provided ON/OFF switch located on the control panel.
- Always place the unit on a dry and stable surface. Do not move or tilt the unit
- The appliance should not be installed in laundry or wet rooms
- Do not use this unit in environments with flammable and explosive gases.
- Avoid keeping the unit in direct sunlight for a long period of time
- For maximum performance the minimum distance from a wall or objects should be 50cm.

FEATURES

- Slim design for seamless home installation.
- High Speed Motor with 6 Fan Speed Settings.
- Swing Function.
- 7-hour standby timer.
- Remote Control allowing all functions to be changed for ease of use.

DIAGRAM

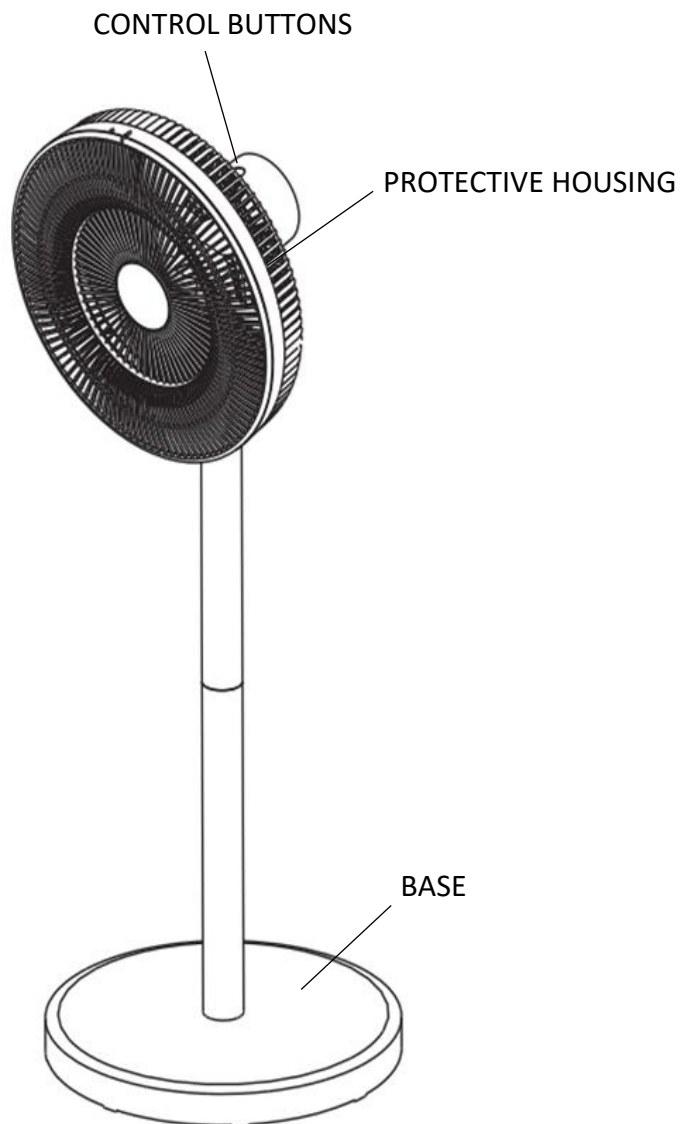



REMOTE CONTROL



For more information see the operation section on page 5.

OPERATION

	<p>SWING BUTTON</p>	<p>Press to start the swing function. The fan will slowly turn from side to side. The swing button light will turn on. Press the button again to turn off the swing function.</p>
	<p>TIMER BUTTON</p>	<p>Press to start the timer function. Each press will increase the timer by 1 hours. The timer function can be set between 1 and 7 hours.</p>
	<p>ON OFF/ FAN SPEED BUTTON</p>	<p>Press the button once to turn on the fan. When the fan is on, press the button repeatedly to cycle through the fan speeds, you can choose between speeds 1-6, when the speed is 4, the indicator will display 1-3. Press and hold the button to turn off the fan.</p>

REMOTE CONTROL

Your fan is supplied with a remote, which allows full control of all the units functions. The Buttons on the remote have the same functions as the buttons on the main control panel.



REPLACING THE BATTERIES

The remote control is powered by a Lithium Button Cell Battery (CR2025). Should the remote become unresponsive, replace the battery following the instructions below:

1. Turn over the remote and press tab A to the right.
2. Slide out the battery tray B.
3. Replace the battery with the same type, ensuring the positive side is facing upwards.

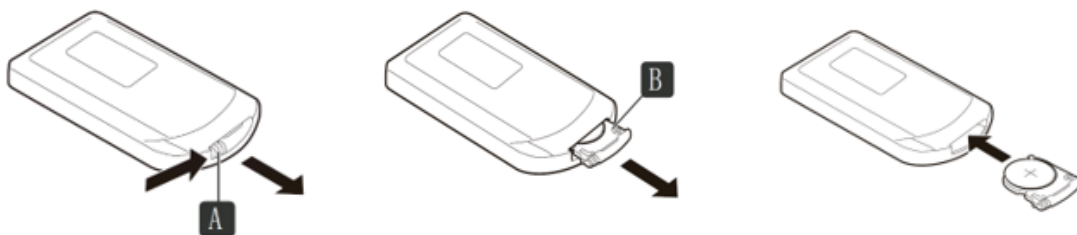

MAINTENANCE

ATTENTION: Turn off the unit and unplug from the mains before cleaning or performing any maintenance.

CLEANING THE SURFACE

- Clean the fan with a duster or a soft wet cloth.
- Do not submerge any part of the fan.
- Do not use chemical solvents (such as benzene, alcohol or gasoline) as they may cause irreversible damage. Make sure no water enters the control panel or fan motor.
- Do not run the unit until completely dry.
- Place the fan in its original box or cover the fan to protect it from dust.
- Store the fan in a cool dry place.

TROUBLESHOOTING

Do not repair or disassemble the unit by yourself, unauthorized repair attempts will invalidate the warranty and may cause bodily harm.

Issue	Possible Reason	Solution
No power	<ol style="list-style-type: none">1. Power cord is unconnected2. There is no power from socket3. The power switch is not on.	<ol style="list-style-type: none">1. Connect the power cord2. Check socket is turned on3. Turn the unit on
Odour emission from unit	<ol style="list-style-type: none">1. New unit. When the unit is used for the first time the fan motor may produce an odour which will dissipate within a week of use	<ol style="list-style-type: none">1. No action required
Strong vibrations and noise	<ol style="list-style-type: none">1. Fan is not used on a flat surface2. Fan may be damaged	<ol style="list-style-type: none">1. Place on a flat surface. May put an anti-vibration mat underneath2. If fan is damaged discontinue use and contact service centre.

If the above solutions do not resolve the problem please contact the supplier.

TECHNICAL DATA

Model	DCF12P
Fan Speeds	6
Cable length (M)	1.5
Rated Input (W)	20
Fan Speed (r/min)	945
Power Supply (V)	12
Net Weight (kg)	1.9
Dimensions (mm)	334 x 334 x900

ENVIRONMENTAL PROTECTION



Recycling facilities are now available for all customers at which you can deposit your old electrical products. Customers will be able to take any old electrical equipment to participating civic amenity sites run by their local councils. Please remember that this equipment will be further handled during the recycling process, so please be considerate when depositing your equipment. Please contact the local council for details of your local household waste recycling centers

electriQ UK SUPPORT

www.electriQ.co.uk/support

Call: 0330 390 3061

Office hours: 9AM - 5PM Monday to Friday

www.electriQ.co.uk

Unit J6, Lowfields Business Park
Lowfields Way, Elland
West Yorkshire, HX5 9DA